



July 26 – 29, 2017

**Kinsmen Sports Centre
Edmonton, Alberta**

Information Package #1

Hosts

Synchro Alberta - Synchro Ontario - Synchro Quebec



1. EVENT INFORMATION

| GENERAL INFORMATION | | | | | | | | | |
|--|--|---------|----------|-------|----------|-------|----------|-------|----------|
| Dates and Location | July 26-29, 2017 Kinsmen Sports Centre, 9100 Walterdale Hill Edmonton, AB | | | | | | | | |
| Hosted by | Synchro Alberta in partnership with Synchro Ontario and Synchro Quebec. | | | | | | | | |
| Meet Manager | Chris Profiri, sync17@shaw.ca Assistant Meet Manager - Jennifer Luzia, jluzia@synchroalberta.com | | | | | | | | |
| Rules | This competition will be conducted under CASSA Rules. Junior National stream rules (Provincial Stream athletes may participate)  13-15 National stream rules (Provincial Stream athletes may participate) 11-12 Provincial stream rules | | | | | | | | |
| REGISTRATION AND PAYMENTS | | | | | | | | | |
| Deadlines for Registration and Payment | <p>Preliminary Entries are due February 15, 2017 Final Entries are due June 14, 2017</p> <p>All registration and entries must be sent using the Synchro Canada E-Sport Event Registration program online with the exception of International Entries which will be provided an entry form.</p> <p>Entry Fees:</p> <table style="margin-left: 20px;"> <tr><td>Figures</td><td>\$ 42.00</td></tr> <tr><td>Solos</td><td>\$ 42.00</td></tr> <tr><td>Duets</td><td>\$ 84.00</td></tr> <tr><td>Teams</td><td>\$160.00</td></tr> </table> <p>Please make cheques payable to Synchro Alberta and send to the following address: Synchro Alberta 11759 Groat Road, Edmonton, Alberta, T5M 3K6, Canada.</p> <p>To confirm registration, a copy of your registration must be sent by email to an address provided in package number 2.</p> <p>Changes to entries can be made on the E-Sport registration site until the deadline. Information recorded on E-Sport will be automatically downloaded into the scoring program.</p> <p>Please ensure that the submitted information is accurate. Any changes after the deadline can be made by email only and will be subject to a late fee (see late entry fees below).</p> | Figures | \$ 42.00 | Solos | \$ 42.00 | Duets | \$ 84.00 | Teams | \$160.00 |
| Figures | \$ 42.00 | | | | | | | | |
| Solos | \$ 42.00 | | | | | | | | |
| Duets | \$ 84.00 | | | | | | | | |
| Teams | \$160.00 | | | | | | | | |



| | |
|--|--|
| | <p>Please note that maximum entries will be accepted up to 20 in solo and duet as follows:</p> <ul style="list-style-type: none"> • Maximum of 1 solo and 1 duet per team, clubs with no team may have up to 2 solos and 2 duets per age group. |
| Official Surcharge | The official surcharge is a one-time fee of \$75.00 per athlete. Please send a cheque payable to Synchro Alberta with the entry form. |
| Cheque Summary | Please note you can send one cheque payable to Synchro Alberta with a breakdown of registration fees and Officials' Surcharge. |
| Late Entry Fee | <p>According to CASSA Rule 5.1.5, fees of \$25 per routine are charged for any late, incorrect and/or incomplete entries by the stated deadline(s), payable to Synchro Alberta.</p> <p>It is the coach's and/or swimmer's responsibility to pay this fine to the appropriate official one hour before the beginning of the competition for that category. Failure to do so shall result in disqualification.</p> <p>The final deadline for late entries is June 30th, 2017 at 11:59 pm. No entries will be accepted after this date.</p> |
| COMMUNICATION & COMPETITION INFORMATION | |
| Email Policy | All correspondence as required will be forwarded by email to those who have sent in their preliminary entries. |
| Communication | All meet information packages and other important communications will be available on the Synchro Alberta website, www.synchroalberta.com |
| Language Policy | All official information packages and correspondence will be provided in English and French. All event announcements will be made in English and French. |
| Figures Draw | The figures draw will be one week prior to the competition and will be posted on the website. |
| Music | All music must be provided digitally. Detailed information to follow in package number 2. |
| Security and Health Services | Trained lifeguards will be on deck at all times during the competition. |
| Photography | All athletes can be photographed and videotaped during the event. Photos and/or videos will be made public, without the authorisation from parents or clubs. |

2. MEETINGS AND REGISTRATION SCHEDULE

Please note this is a tentative schedule and subject to change based on preliminary entries received.

| Events / Meetings | Location | Date |
|--|----------|-------------------|
| Athlete, Coach and Official Registration | Pool | Wednesday July 26 |
| Delegation meeting: (information to coaches) | Pool | Wednesday July 26 |
| SYNC welcome party (athletes and coaches) | TBA | Wednesday July 26 |
| Chief Referee and Officials meeting | Pool | Thursday July 27 |
| SYNC VIP Reception (officials, head of delegation and VIP) | TBA | Thursday July 27 |

3. PRELIMINARY COMPETITION ORDER OF EVENTS (subject to change following preliminary and final entries)



| Wednesday July 26 | Thursday July 27 8h00 à 21h00 | Friday July 28 10h30-21h00 | Saturday July 29 08h00-21h00 |
|----------------------|---|---|---|
| Arrival | Practice for 11-12 Solo 13-15 Solo Junior Solo | 11-12 Figures 13-15 Figures Junior Figures | 11-12 Team 13-15 Team Junior Team |
| | 11-12 Solo 13-15 Solo Junior Solo | 11-12 Duet 13-15 Duet Junior Duet | |
| | Practice for 11-12 Duet 13-15 Duet Junior Duet | 11-12 Team (music) 13-15 Team (music) Junior Team (music) | |



4. PRELIMINARY ENTRY FORM

Due on or before February 15, 2017, email to sync17@shaw.ca & copy jluzia@synchronalberta.com.

Name of Federation/Club :

Name of Primary contact :

Email Address of Primary contact for future correspondence :

| | # of Figures | # Of Solos | # Of Duets | # Of Teams | # Coaches | Total # of swimmers |
|--------|--------------|------------|------------|------------|-----------|---------------------|
| 11-12 | | | | | | |
| 13-15 | | | | | | |
| Junior | | | | | | |

| Anticipated Host Hotel Information | Singles | Doubles | Triples | Quad | Total # Of Rooms |
|------------------------------------|---------|---------|---------|------|------------------|
| # Of Rooms | | | | | |
| # Of Nights | | | | | |

We understand there may be some changes to your overall entries and needs. Providing your best estimates will help the organizing committee significantly. Thank you !

PRELIMINARY ENTRIES DUE BY FEBRUARY 15, 2017

5. POOL LAYOUT

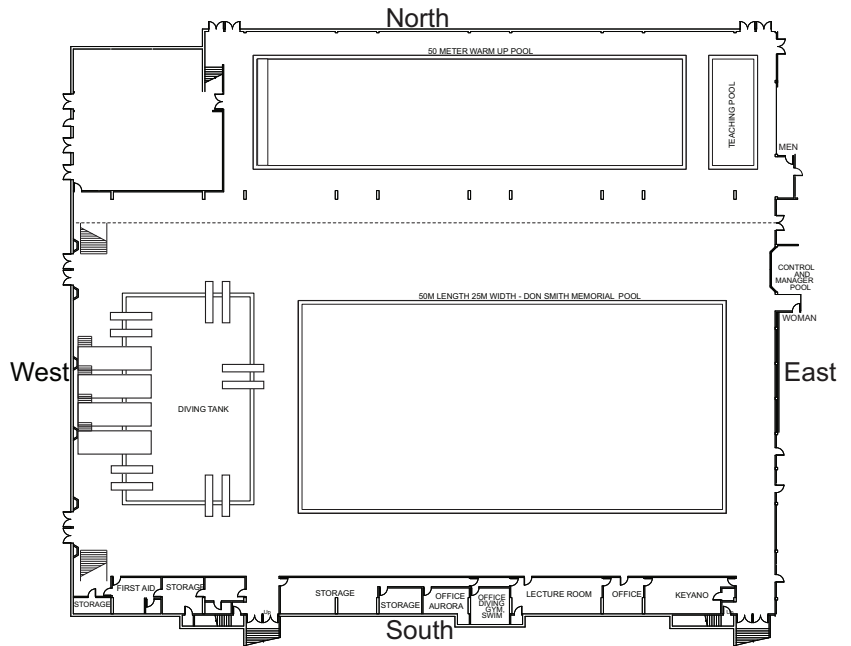

6. TRANSPORTATION

Transportation to and from the pool is the responsibility of the individual clubs. The airport is about a 40 minutes drive to the hotel and pool facility, outside of rush hour times.

Car rentals are available at the airport, book rentals early.

7. HOST HOTEL INFORMATION

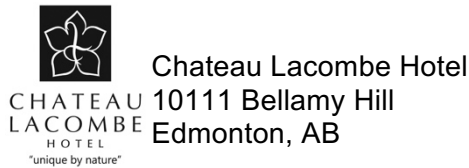

| | Single | Double | Triple | Quad |
|-----------------|----------|----------|----------|----------|
| Standard Double | \$125.00 | \$132.00 | \$139.00 | \$152.00 |
| Concierge King | \$155.00 | \$155.00 | | |
| Jr. Suite | \$175.00 | \$175.00 | \$190.00 | \$205.00 |

Room rates includes full hot breakfast buffet per person. These rates are net of taxes and subject to applicable provincial and local taxes and 3% destination marketing fee.

Parking is \$10/vehicle/day.

Synchro Alberta is currently looking into the option of dinner being available at the hotel for an additional cost of \$25.00 inclusive of tax and gratuity/person. More information to follow in package #2.